

A town full of history and culture

# HIMEJI

**Himeji Convention & Visitors Bureau**

670-0012 68, Honmachi, Himeji-shi Tel: 079-222-2310

URL: <https://www.himeji-kanko.jp/convention/>

E-mail: [convention@himeji-kanko.jp](mailto:convention@himeji-kanko.jp)

Published in Aug. 2024



# HIMEJI

Convention Guide

# Himeji



Himeji Castle



Himeji Culture and Convention Center  
Arcrea HIMEJI

Himeji Station

About 700m

## Contents

- Himeji Culture and Convention Center ..... 03~04
- Convention Facilities ..... 05~14
- Convention Facilities – Hotels ..... 15~18
- Convention-Facilities (Sports) ..... 19~20

- Access ..... 02
- Reception Halls ..... 21~22
- Unique Venues ..... 23
- Sightseeing and Excursions ..... 24
- Hotels ..... 25~26
- Himeji City Convention Facilities & Hotels Map ..... 27~28
- Subsidies ..... 29
- Other Support ..... 30

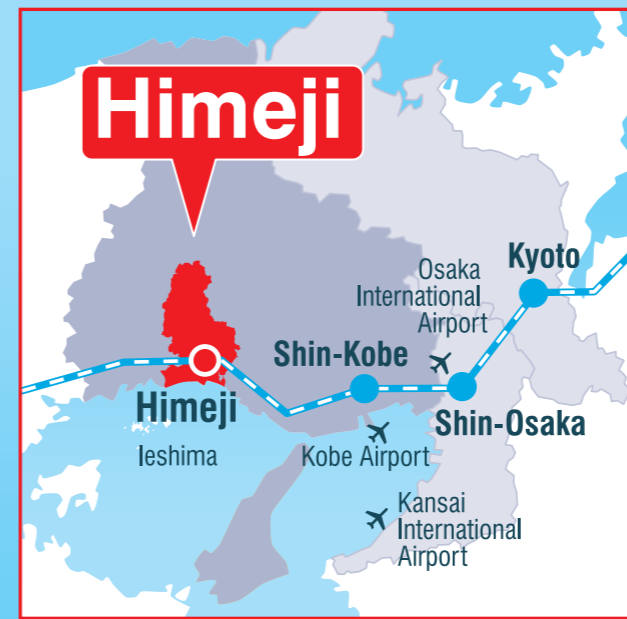

## Shinkansen

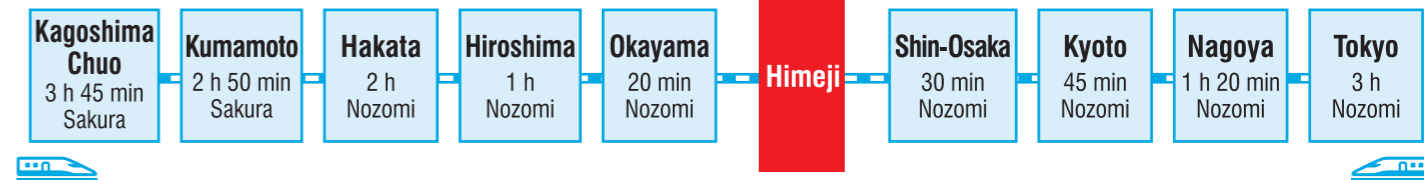

## Electric train

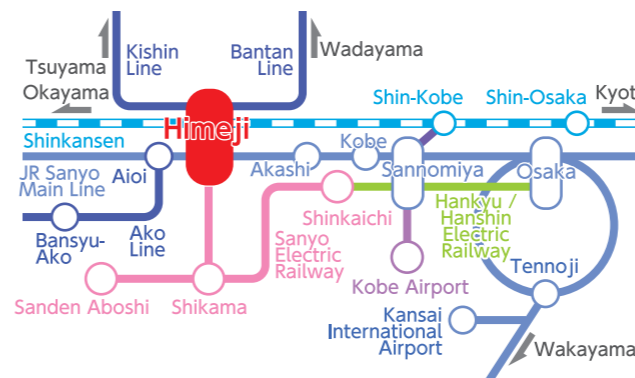

### ◀JR Special Rapid Service▶

- Osaka—Himeji ..... 60 min
- Kobe / Sannomiya—Himeji ..... 40 min

### ◀Sanyo train direct limited express▶

- Umeda—Himeji ..... 100 min
- Kobe / Sannomiya—Himeji ..... 70 min

## Airplane

- ◀From Kansai International Airport▶
  - By airport limousine bus ..... About 2 h
- ◀From Osaka International Airport▶
  - By airport limousine bus ... About 1 h 20 min
- ◀From Kobe Airport▶
  - By port liner + JR ..... About 1 h

## Highway

- ◀From Osaka / Kobe▶  
Hanshin Expressway No.3 Kobe Line » Daini Shinmei Road » Kakogawa bypass » Himeji bypass » Himeji south ramp (Get off)  
Chugoku Expressway » Sanyo Expressway » Sanyo Himeji East IC (Get off)
- ◀From Okayama / Hiroshima▶  
Route 2 » Himeji bypass » Himeji south ramp (Get off)  
Sanyo Expressway » Sanyo Himeji West IC (Get off)  
Chugoku Expressway » Yumesaki Smart IC (Get off)

# Himeji Culture and Convention Center Arcrea HIMEJI



Grand Hall



Medium Hall



Small Hall

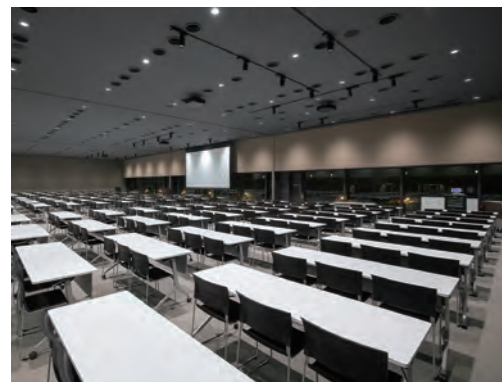

Conference Room



Exhibition Hall

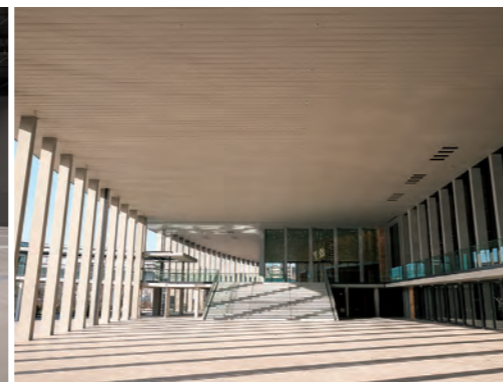

Outdoor Exhibition Space

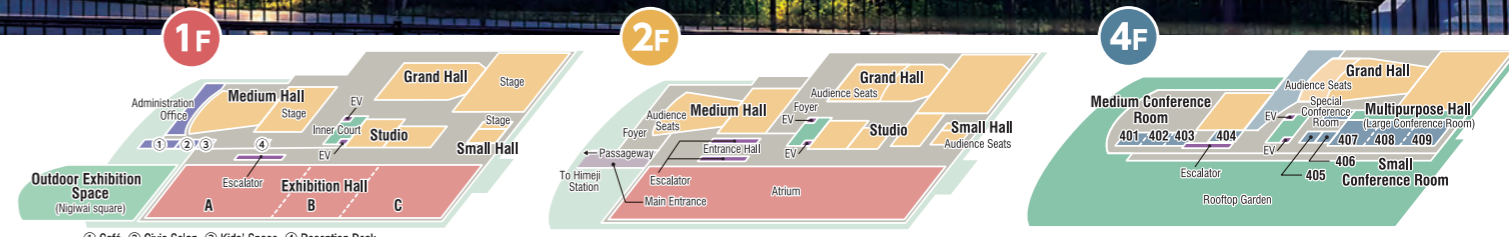

<b>4F</b> Conference Room	Multipurpose hall (Large meeting room)	About 690m <sup>2</sup> *Can be divided into three
	Middle meeting room	About 80m <sup>2</sup> × 5 rooms
	Small meeting room	About 35m <sup>2</sup> × 2 rooms

<b>2F</b> Culture Hall	Grand hall	2,010 seats
	Medium hall	693 seats
	Small hall	164 seats
	Other facilities	Main studio (Rehearsal room) Studio

<b>1F</b> Exhibition Hall	About 4,000m <sup>2</sup> (107m×37.4m) *Can be divided into three
------------------------------	---

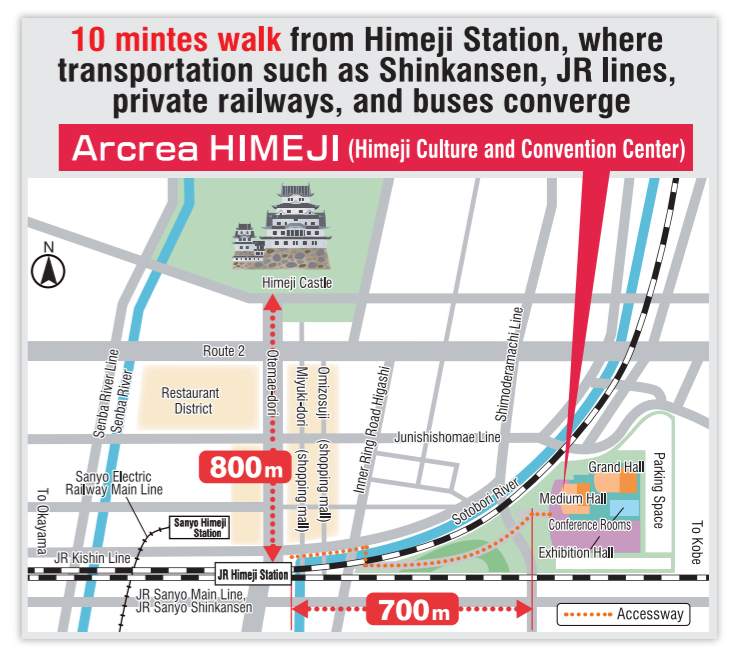



Located in front of Himeji Castle I-messae Hall accommodates up to 320 people.

# Egret Himeji

\*3F / Himeji City Gender Equality Promotion Center  
 4F / Himeji City International Exchange Center /  
 Himeji City Human Rights Awareness Center  
 B1F, B2F / Himeji Citizens Plaza

**Address:** 670-0012 Honmachi 68-290  
**Tel:** (079) 287-0800 (3F/4F facilities) / (079) 287-0830 (B1F / B2F facilities)  
**Holidays:** 12/28 - 1/4, closed one designated Monday per month  
**WiFi:** Available (in some areas)  
**Parking:** Egret underground parking lot: 255 cars / Otemae Park underground parking lot: 346 cars (fees apply)  
**URL:** <http://www1.winknet.ne.jp/~egret-himeji/>

Located in front of Himeji Castle, a World Heritage Site and National Treasure, this venue features an attractive hall, meeting rooms, and an exhibition room. I-messae Hall accommodates up to 320 people (280 fixed seats and 40 supplementary seats). Himeji Castle can be seen from its 3rd floor, 4th floor lobby, and rooftop.



**I-messae Hall**  
 A multipurpose hall equipped with audiovisual equipment. Accommodates up to 320 people with a writing desk at all seats. Depending upon the event, the seats and stage can be stored and the hall can be used as an exhibition space.

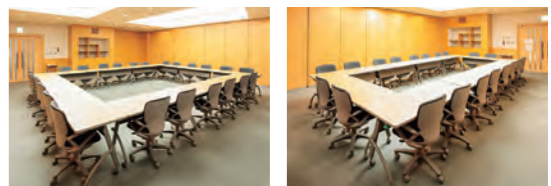

Meeting Room 1 Meeting Room 2



Meeting Room 1 & 2 (when connected)



Meeting Room 3



Art Hall

\*Meeting Rooms 4, 5, and 6 can be combined.



Meeting Room 4



Citizen Arena A

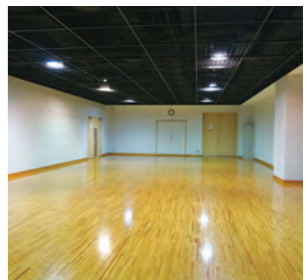

Citizen Arena B

■ 3-4F

Venue name	Floor	Area (m <sup>2</sup> )	Capacity (persons)
I-messae Hall	3	474	280+(40)
Studio	3	71	25
Cooking room	3	149	25
Fitness Room	3	155	25
Meeting Room 1	4	101	24
Meeting Room 2	4	61	20
Meeting Room 3	4	69	14
Meeting Room 4	4	30	8

Venue name	Floor	Area (m <sup>2</sup> )	Capacity (persons)
Meeting Room 5	4	27	8
Meeting Room 6	4	29	8
Seminar Room A	4	123	56
Seminar Room B	4	69	28
Seminar Room C	4	48	20
Seminar Room D	4	52	20
Japanese-Style Room 1 (Koyoon)	4	55	24
Japanese-Style Room 2 (Koyoon)	4	49	24

Meeting Rooms 1 and 2 can be combined. Meeting Rooms 4, 5, and 6 can be combined. Seminar Rooms C and D can be combined.

■ B1-B2F

Venue name	Floor	Area (m <sup>2</sup> )	Capacity (persons)
Special Exhibition Room	B1	158	-
Exhibition Room 1	B1	86	-
Exhibition Room 2	B1	129	-
Exhibition Room 3	B1	188	-
Exhibition Room 4	B1	181	-
Arena A	B2	233	-
Arena B	B2	178	-
Art Hall	B1	140	120

Exhibitions Rooms 1 and 2 can be combined. Exhibitions Rooms 3 and 4 can be combined.



Seminar Room A



Seminar Room B



Seminar Room C & D (when connected)

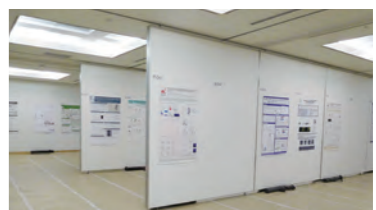

Exhibition Room

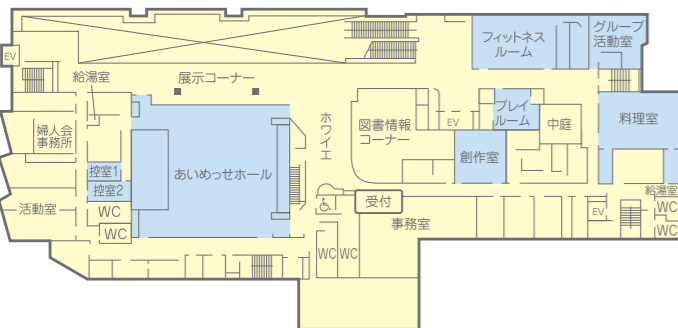

**3F** Himeji City Gender Equality Promotion Center

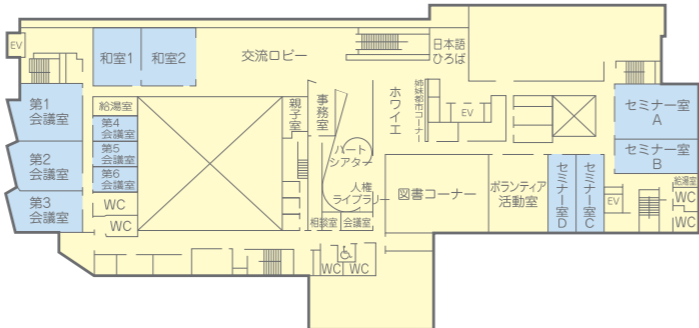

**4F** Himeji City International Exchange Center / Himeji City Human Rights Awareness Center

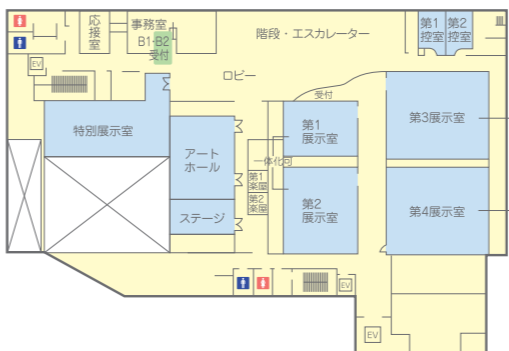

**B1F** Himeji Citizens Plaza (Himeji Citizens Gallery)

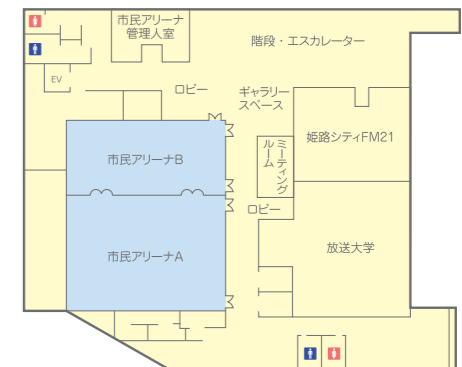

**B2F** Himeji Citizens Plaza (Himeji Citizens Arena)



Parking available for 270 cars. WiFi available.

# Himeji Chamber of Commerce and Industry

The facility is suited to meet a variety of needs, featuring an exhibition hall and large hall, as well as meeting rooms for groups of 16 - 180. It can also be used for social gatherings and parties.

**Address:** 670-8505 Shimodera-machi 43  
**Tel:** (079) 223-6551  
**Holidays:** Year-end and New Year's holidays  
**WiFi:** Available  
**Parking:** 270 cars (fee applies)  
**URL:** <https://www.himeji-cci.or.jp/>  
**E-mail:** [info@himeji-cci.or.jp](mailto:info@himeji-cci.or.jp)  
**Notes:** Restaurant (Seiko Club: 079-281-6800)

MAIN BUILDING

Venue name	Floor	Area (m <sup>2</sup> )	Capacity (persons)
Exhibition Hall Main Building	1	377	300
Large Hall Main Building	2	463	500
Special Meeting Room Main Building	3	159	40
Special Room Main Building	3	46	14
Japanese-style Room Main Building	4	50	15
Meeting Room 402 Main Building (Rectangular table setup)	4	43	16
Meeting Room 403 Main Building (Rectangular table setup)	4	56	22
Hall 501 Main Building (Classroom setup)	5	268	180
Meeting Room 502 Main Building (Classroom setup)	5	86	60
Meeting Room 503 Main Building (Classroom setup)	5	86	60
Meeting Room 601 Main Building (Classroom setup)	6	73	30
Meeting Room 602 Main Building (Classroom setup)	6	86	60
Meeting Room 603 Main Building (Classroom setup)	6	86	60
Meeting Room 604 Main Building (Rectangular table setup)	6	73	30
Meeting Room 605 Main Building (Classroom setup)	6	165	105
Hall 701 Main Building (Classroom setup)	7	208	138
Hall 702 Main Building (Classroom setup)	7	140	105

NEW BUILDING

Venue name	Floor	Area (m <sup>2</sup> )	Capacity (persons)
New Training Room 201 Annex (Classroom Setup)	2	179	117
New Meeting Room 202 Annex (Rectangular table setup)	2	50	24
New Meeting Room 301 Annex (Rectangular table setup)	3	59	20

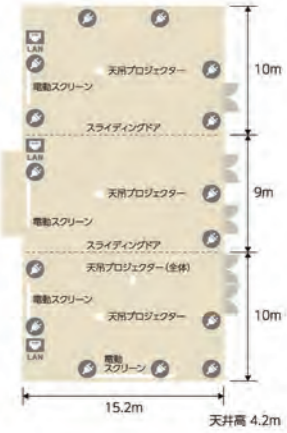

2F Large Hall Theater-style: 500 / School-style: 396 (3 per table), 264 (2 per table)



Reception Hall



Hall 701 School-style: 138 (3 per table), 92 (2 per table)



Reception Hall

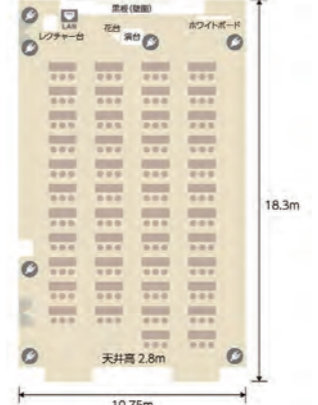

Hall 702 School-style: 105 (3 per table), 70 (2 per table)



Reception Hall



Exhibition Hall

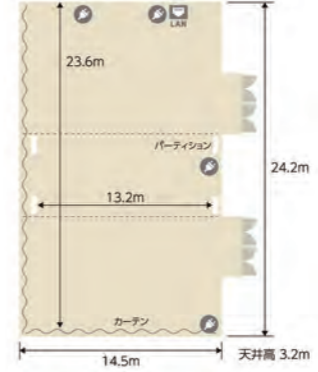

Reception Hall

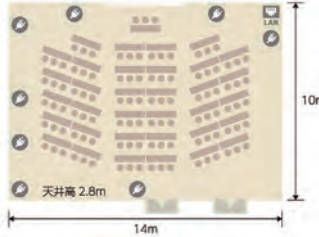

Meeting Room 402



Meeting Room 502 / 503



Hall 501 School-style: 180 (3 per table), 120 (2 per table)

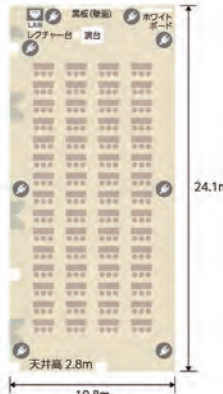



This community facility can be used for multiple purposes.

# Himeji Citizens' Hall

Conveniently located just a 15-minute walk from Himeji Station, this multi-purpose community facility is equipped with a large hall that accommodates 800 people, as well as multiple meeting rooms including Meeting Room 2 (Middle Hall) that accommodates 200 people.

**Address:** 670-0015 Shosha Honmachi 112  
**Tel:** (079) 284-2800 (2F-5F facilities)  
**Holidays:** Once per month (irregular day), 12/28 - 1/3  
**WiFi:** None  
**Parking:** Available nearby (public)  
**URL:** <http://www.city.himeji.lg.jp/s30/2842800.html>  
**Email:** Email inquiry form available.  
**Notes:** Café available.

Venue name	Floor	Area (m <sup>2</sup> )	Capacity (persons)
Large Hall	2	1,870	800
Dressing Room 1	2	13.4	5
Dressing Room 2	2	14.3	5
Dressing Room 3	2	36.8	15
Exhibition Room	2	190.9	-
Special Meeting Room	3	68.1	8
Meeting Room	3	89.1	60
Meeting Room 2 (Middle Hall)	3	227.5	200
Meeting Room 2 Waiting Room (Middle Hall Waiting Room)	3	26.9	12
Meeting Room 3	4	88.0	60
Meeting Room 4	4	75.4	50
Meeting Room 5	4	79.4	50
Meeting Room 6	4	161.0	100
Meeting Room 7 (Japanese-style room 1)	4	75.5	40
Meeting Room 8 (Japanese-style room 2)	4	52.6	25
Meeting Room 9	3	29.0	15
Meeting Room 10	4	88.0	30
Meeting Room 11	5	101.7	34
Classroom 1 (including preparation room)	5	104.2	55
Classroom 2	5	70.2	50
Clothing Classroom	5	77.8	30
Tea Ceremony Classroom	5	79.0	20
Music Classroom	5	82.0	45
Cooking Classroom	5	138.8	35

Front-facing view of stage



Large Hall audience seating

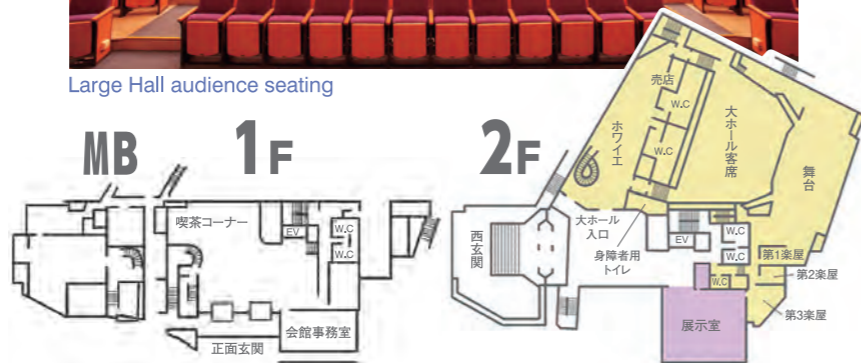

Meeting Room 2 (Middle Hall)



Meeting Room 1



Exhibition Room



Meeting Room 4



Meeting Room 10





Located at the South Exit of JR Himeji Station, this easily located building is the perfect facility for meetings that welcome guests from afar.

Address: 670-0962 Minamiekimae-cho 123  
 Tel: (079) 289-2832  
 Holidays: 12/29 - 1/3  
 WiFi: Available  
 Parking: 60 cars (fee applies)  
 URL: <http://jibasan.or.jp/>  
 E-mail: [info@jibasan.or.jp](mailto:info@jibasan.or.jp)

Venue name	Floor	Area (m <sup>2</sup> )	Capacity (persons)
Room 401	4	100	54
Room 402	4	42	16
Room 403	4	29	8
Room 404	4	51	20
Room 501	5	117	72
Room 502	5	82	42
Room 503	5	61	28
Room 601	6	117	72
Room 602	6	82	42
Room 603	6	61	28
Room 901	9	270	180



Local specialties corner "Bansankan"



Room 901



Room 501



Room 401



Room 404



Room 502



Room 601



Room 602

Jibasan Bldg.

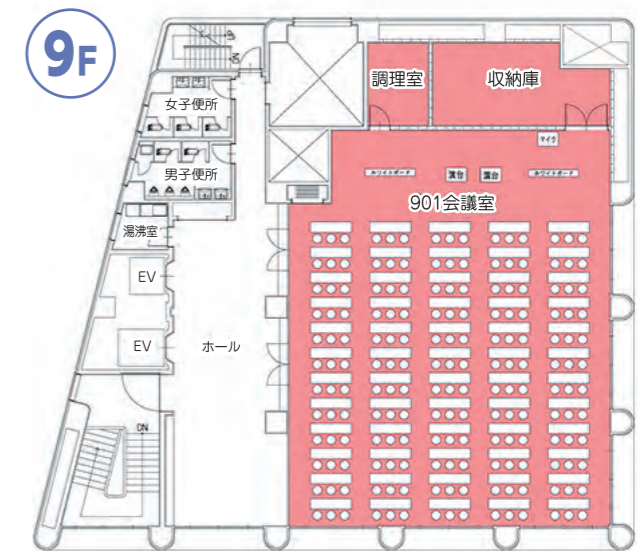
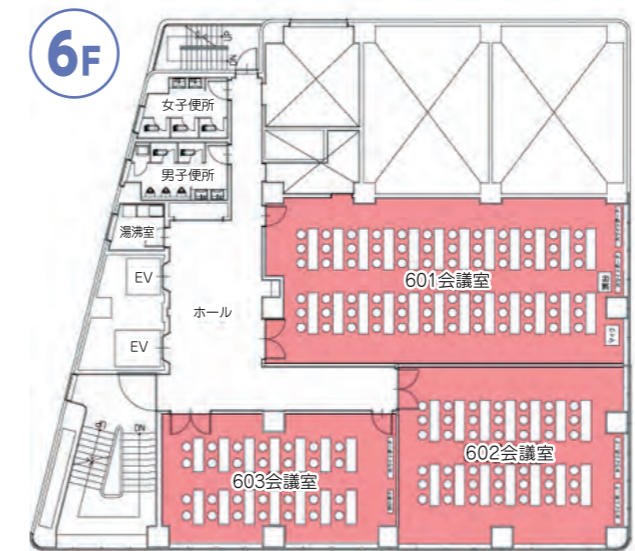
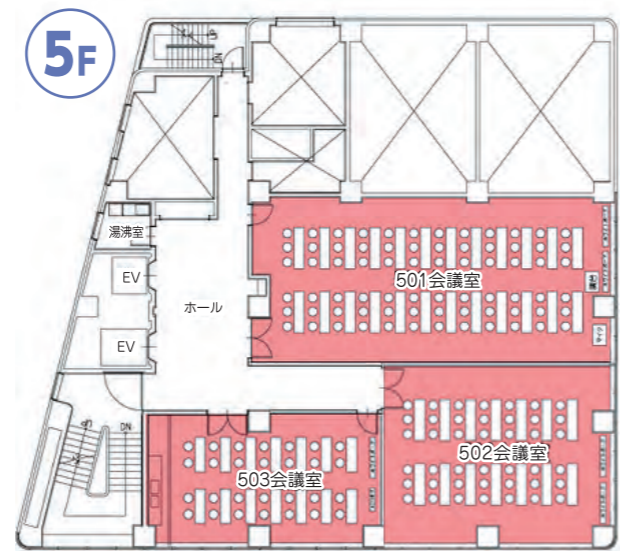
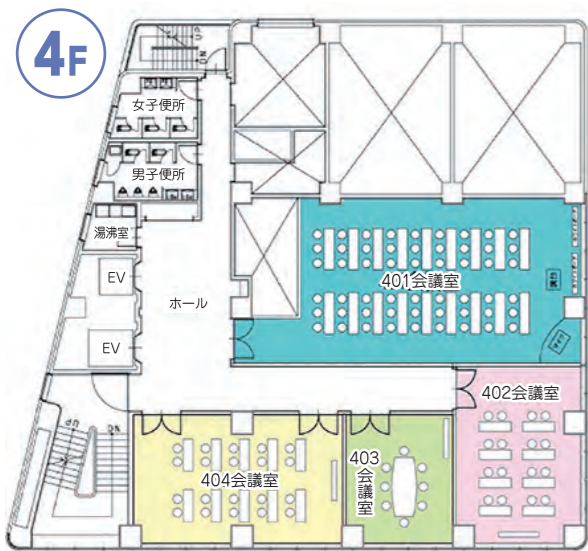

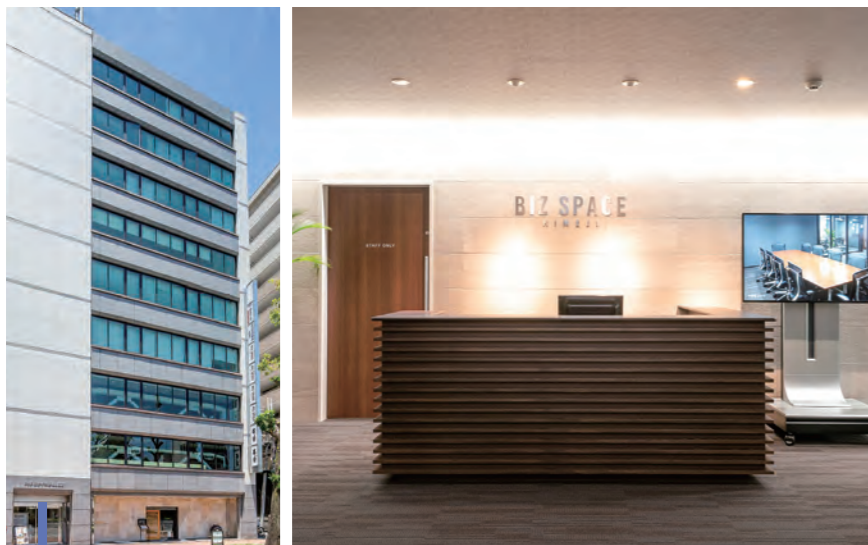

### BIZ SPACE HIMEJI

There are venue variations ranging from 10 people to a maximum of 144 people (school style) with a combination of 10 patterns in 9 rooms. You can freely lay out and use large-scale seminars and small meetings.

**Address:** 670-0012 Honmachi 127  
 Otemae Dainen BLD.Ⅱ 3-6F  
**Tel:** (079) 226-0130  
**Holidays:** None **WiFi:** Available  
**Parking:** Available nearby (public)  
**URL:** <https://biz-space.info/>  
**E-mail:** support@biz-space.info

Venue name	Floor	Area (m <sup>2</sup> )	Capacity (persons)
Meeting room 401	4	18	10
Meeting room 402	4	18	10
Meeting room 403	4	72	36
Meeting room 404	4	75	36
Middle hall 501	5	124	60
Middle hall 502	5	121	60
Large hall 5F	5	250	144
Large hall 601	6	250	144
Meeting room 901	9	43	16
Meeting room 902	9	42	10
Meeting room 903	9	60	36



Meeting room 404



Middle hall 502



Large hall 601

Lobby



### Himeji Harvest Medical Welfare College

The school is available for use on days when it does not interfere with the school's operations. Please consult with us in advance. As a rule, the hours of use are from 9:00 a.m. to 9:00 p.m. If you wish to use the room outside of these hours, please consult with us and if available, an extra charge will be added to the rental fee. A minimum of two rooms per group is required. Please consult with us if you wish to reserve the entire building.

**Address:** 670-0962 Minamiekimae-cho 91-6  
**Tel:** (079) 224-1777 **Holidays:** None **WiFi:** Available  
**Parking:** Available nearby (public)  
**URL:** <http://www.harvest-school.com/recruit/rental.html>

Venue name	Floor	Area (m <sup>2</sup> )	Capacity (persons)
lecture hall	101	185	120~140
Back of the lounge	1	36	22
reception room	106	10	6
classroom	201	73	40
classroom	202	73	40
classroom	203	78	40
kitchen practice room-home economics practice room	205	96	54
classroom	301	78	40
classroom	303	78	40
lounge	304	73	40
practice room	306	126	50
classroom	401	73	40
classroom	402	73	40
classroom	403	78	40
treatment room	405		
functional training room	406	272	66
classroom	501	73	40
classroom	502	73	40
classroom	503	78	40
ADL Room	506	95	40
training room	507	98	36



lecture hall



classroom



### Himeji Caspa Hall

Located on the 7th floor of Caspa Building adjacent to Himeji Station of Sanyo Railway. This is a high-grade multi-purpose hall that can be used for plays, dances and concerts.

**Address:** 670-0913 Nishiekimae-cho 88 Caspa 7F  
**Tel:** (079) 284-5806  
**Holidays:** 12/29 - 1/3  
**WiFi:** None  
**Parking:** Available nearby (public)  
**URL:** <http://caspahall.himeji-culture.jp/>  
**E-mail:** caspa@beach.ocn.ne.jp

Venue name	Floor	Area (m <sup>2</sup> )	Capacity (persons)
Hall	7	778	Fixed seat 331

\*There are 6 dressing rooms (9-34 square meters)

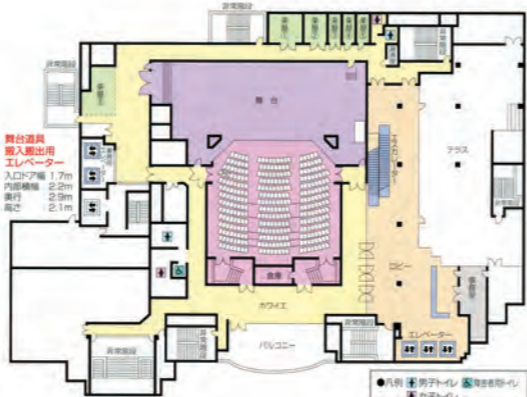
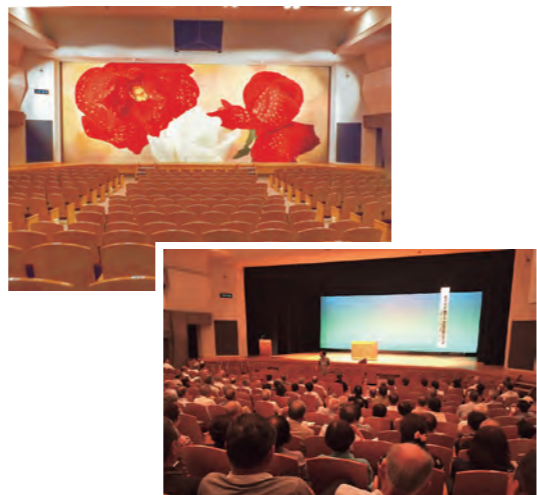

### Earth Cinemas Himeji

Up to 11 sessions can be held simultaneously on 11 large screens. Direct access from Himeji Station on the Nozomi line.

**Address:** 670-0927 Ekimae-cho 27  
**Tel:** (079) 287-8810  
**Holidays:** None  
**WiFi:** None  
**Parking:** 350 cars  
**URL:** <http://earthcinemas.jp/>  
**E-mail:** Please contact the Himeji Convention & Visitors Bureau with any inquiries.

Venue name	Capacity (persons)
Screen 1	183
Screen 2	83
Screen 3	192
Screen 4	Not available
Screen 5	334
Screen 6	254
Screen 7	79
Screen 8	187
Screen 9	340
Screen 10	84
Screen 11	87
Screen 12	87



Screen 5



Aisle



Lobby





The hotel is conveniently located just one minute's walk from JR Himeji Station. From the bar lounge on the top floor, you can see Himeji Castle lit up at night, and from the guest rooms you can enjoy watching the Shinkansen trains come and go. The breakfast is served buffet style with a wide variety, incorporating quality ingredients grown in the local climate.

**Address:** 670-0962 Minamiekimae-cho 100  
**Tel:** (079) 222-2231  
**WiFi:** Available  
**Parking:** 250 cars (1,000 yen per night)  
**URL:** <http://www.hotelnikkohimeji.co.jp/>  
**Notes:** Restaurant, café, and chapel available

Venue name	Floor	Area (m <sup>2</sup> )	Capacity (persons)			
			Theater-style	School-style	Formal dinner	Cocktail style
Korin	3	672	560	315	300	400
Korin 3	3	267	220	105	90	100
Korin 1 & 2	3	405	340	195	150	150
Shinju	3	229	220	105	90	100
Fuji	3	108	80	48	50	50
Hagi	3	104	75	48	40	50
Tsuru Kame	4	45	—	24	—	—
Matsu-Take	4	45	—	24	—	—
Ume	4	65	50	36	—	—
615	6	30	—	12	—	—
618	6	45	—	16	—	—

### Hotel Nikko Himeji



Korin Theater



Korin-no-ma



Fuji-no-ma



Shinju-no-ma



Buffet Restaurant



Bar Lounge



Tea Lounge



This hotel is a multi-function hotel, spa, and banquet facility with chic guest rooms in black and white color tones, a rock bath and private bath, the Iki sauna, a hot rock sauna, beauty treatments, and a barber. It offers location, functionality, and comfort so that you can fully enjoy Himeji.

**Address:** 670-0940 Sanzaemonbori nishi-no-machi 210  
**Tel:** (050) 5847-7755, (050) 5847-7770  
**WiFi:** Available  
**Parking:** 180 cars (free), 10 medium vehicles, large vehicles, or buses (reservation required): 1,000 yen  
**URL:** <https://www.himejicastlehotel.co.jp/>  
**Notes:** Restaurant, café, and public bath (natural hot spring) available.

Venue name	Floor	Area (m <sup>2</sup> )	Capacity (persons)			
			Theater-style	School-style	Formal dinner	Cocktail style
Hoo	3	627	700	550	350	600
Nishiki-Ogi	3	390	450	270	200	240
Miyabi-Ogi	3	390	450	270	200	240
Nishiki	3	238	250	150	120	150
Ogi	3	152	150	80	70	80
Miyabi	3	238	250	150	120	150
Sagi-so	2	201	200	120	100	120
Matsu-Take	2	168	150	100	80	100
Matsu	2	84	70	48	40	50
Take	2	84	70	48	40	50
Sakura-Momo	2	85	80	48	40	50
Sakura	2	42	40	24	20	25
Momo	2	42	40	24	20	25
Kikyo	4	68	60	42	—	—
Kiku	4	45	25	18	—	—
Ran	4	30	20	15	—	—
Hana	4	55	40	30	—	—
Kiri	2*	42	—	—	24	—
Aoi	2*	42	—	—	24	—
Katsura	2*	42	—	—	24	—
Kaede	2*	36	—	—	12	—

\*tatami seating

### Himeji Castle Grandvrio Hotel

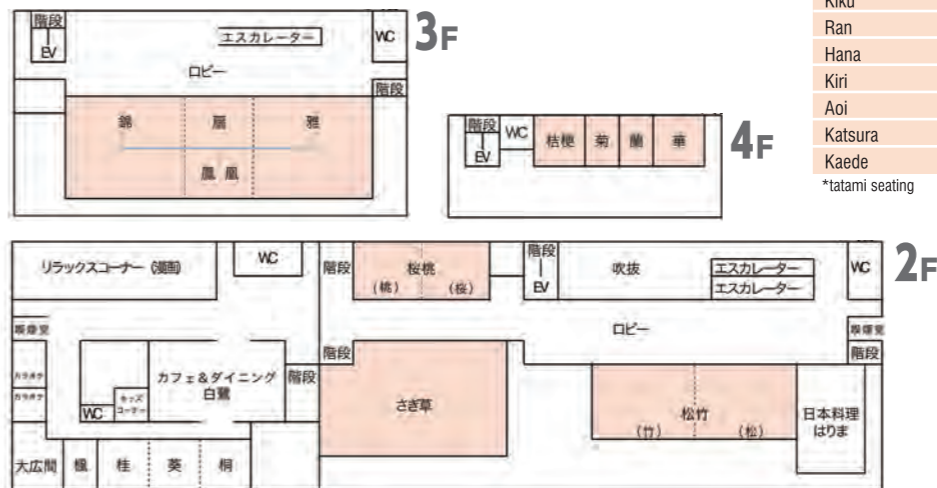

Kikyo-no-ma



Hoo-no-ma



Hana-no-ma



Aoi-no-ma



## Hotel Monterey Himeji

Located in front of Himeji Station in Himeji, Hyogo, home to Himeji Castle, the World Heritage Site and National Treasure, this metropolitan hotel is equipped with 274 guest rooms, a sky chapel, banquet halls, and a restaurant. The hotel is conveniently located just a 15-minute walk from Himeji Castle and is connected to JR Himeji Station.

**Address:** 670-0927 Ekimae-cho 60 **Tel:** (079) 224-7111  
**WiFi:** Available  
**Parking:** Capacity for 197 cars (fees apply, first-come, first served)  
**URL:** <https://www.hotelmonterey.co.jp/himeji/>  
**Notes:** Restaurant, chapel

Venue name	Floor	Area (m <sup>2</sup> )	Capacity (persons)			
			Theater-style	School-style	Formal dinner	Cocktail style
Entire room	3	685	550	357	400	600
Lucerna 1	3	301	250	147	150	200
Chiaro 2	3	174	150	72	80	100
La Festa 3	3	210	170	105	100	120
Lucerna 1 & 2	3	475	450	252	250	500
La Festa 2 & 3	3	384	300	189	200	350
Serenade	3	75	—	—	30	40
Minuet	3	75	—	—	30	40
Ciel	14	210	160	108	100	120



14F Banquet Hall (image for illustrative purposes only)



Foyer 3F Banquet Hall (image for illustrative purposes only)

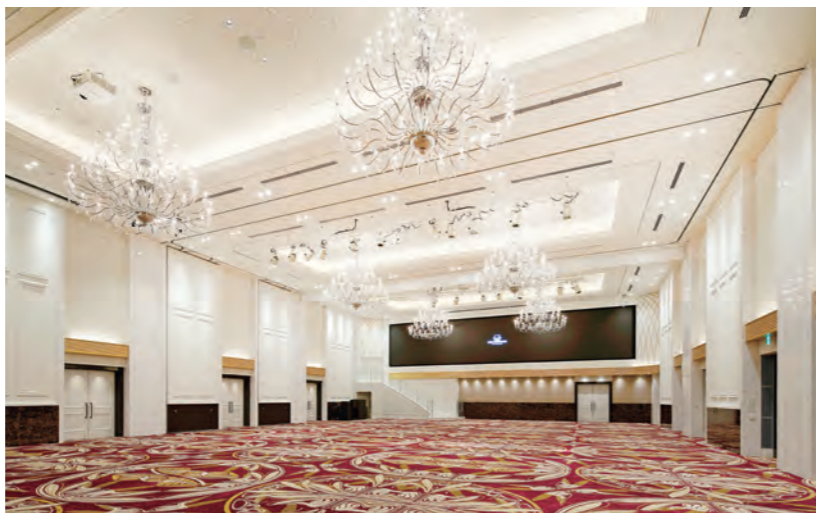

3F Large Banquet Hall (image for illustrative purposes only)



## Yume-no-i (Shiota Hot Springs)

30 minutes by car from JR Himeji Station 2 minutes from Chugoku Expressway Yumesaki Smart IC. Himeji's back room, Shiota Onsen Village.

**Address:** 671-2103 Yumesaki-cho Maenosho 187  
**Tel:** (079) 336-1000  
**WiFi:** Available  
**Parking:** 100 cars  
**URL:** <http://www.yumenoi.com/>  
**Notes:** Restaurant & banquet hall, open-air bath, large public bath, meeting rooms (up to 200 people), pool, walkway

Venue name	Floor	Area (m <sup>2</sup> )	Capacity (persons)			
			Theater-style	School-style	Formal dinner	Cocktail style
Nobushi-no-ma	2	215.6	200	150	80	120
Shirasagi-no-ma 1	2	118.8	110	80	40	60
Shirasagi-no-ma 2	2	96.8	80	50	32	48
Shirasagi-no-ma (Japanese style seating and tables)						



Nobushi-no-ma



Shirasagi-no-ma



Shirasagi-no-ma (Japanese style seating and tables)



Lobby



Gallery



## Hotel Sunshine Aoyama

This great hotel is surrounded by the natural environment. Conveniently located just 300 m along National Route 2 from the Himeji Bypass Taishi Higashi Interchange.

**Address:** 671-2223 Aoyama-minami 4-7-29  
**Tel:** (079) 276-1181 **WiFi:** Available  
**Parking:** 400 cars (free) \*Accommodates large vehicles  
**URL:** <https://www.hotel-sunshineaoyama.co.jp/>  
**Notes:** Restaurant, café



Sunshine



Plaza Hall



Peacock

### Hotel Sunshine Aoyama (Main Building)

Venue name	Floor	Area (m <sup>2</sup> )	Capacity (persons)			
			Theater-style	School-style	Formal dinner	Cocktail style
Sunshine (A) & (B) & (C) & (D)	2	558.7	620	420	300	400
Aurora (A) & (B) & (C)	2	437.9	480	315	240	300
Rainbow (A) & (B)	2	317.1	340	225	180	200
Tenpyo (A)	2	196.3	200	120	90	120
Momoyama (B)	2	120.8	—	72	60	72
Heian (C)	2	120.8	—	72	60	72
Kamakura (D)	2	120.8	—	72	60	72
Country House	2	151.0	140	81	80	96
Manhattan Dream	2	151.0	140	81	80	96
Fuyo*	3	14.7	—	—	10	—
Yamabuki	3	53.7	30	30	30	30
Japanese-style Rooms 1 & 2 (both)	3	49.7	—	—	—	—
Japanese-Style Room 1 (Front)	3	30.2	—	—	—	—
Japanese-Style Room 2 (Rear)	3	19.4	—	—	—	—

\*Japanese-style room with 10 tatami mats

### Sunshine Garden Plaza (Annex)

Venue name	Floor	Area (m <sup>2</sup> )	Capacity (persons)			
			Theater-style	School-style	Formal dinner	Cocktail style
Plaza Hotel	5	858.9	750	500	432	800
Manyo (A) & (B) & (C) & (D)	4	477.4	650	345	300	600
Hoo (A) & (B) & (C)	4	361.2	480	255	216	300
Shirasagi (A) & (B)	4	232.5	280	150	120	180
Peacock (A)	4	244.9	300	195	144	200
Hakucho (B)	4	116.3	140	72	72	80
Kocho (C)	4	116.3	140	72	72	80
Hagi (D)	3	82.8	—	—	48	—
Aoi	3	82.8	—	—	48	—
Étoile	3	63.4	60	36	40	—
Kaede	2	49.6	—	—	36	—
Orion	2	62.7	48	36	36	45
Pegasus	2	62.7	48	36	36	45



# Hyogo Prefecture Budokan

**Address:** 670-0971 Nishinobusue 504 **Tel:** (079) 292-8210  
**Holidays:** Mondays (Tuesdays if Monday falls on a national holiday), 12/29 - 1/3  
**WiFi:** Available (in some areas) **Parking:** About 200 cars (public)  
**URL:** <http://www.hyogokenritsu-budokan.jp>  
**Notes:** Restaurant (open Saturday, Sunday, national holidays, and some other days)

One of the largest in Japan, this budokan is equipped with large screens and can be used for various purposes, including martial arts.

Venue name	Floor	Area (m <sup>2</sup> )	Capacity (persons)	
Dojo 1	1	1,263	1,980	
Dojo 2	All courts (4 of 4)	1	2,300	1,034
	Partial use (3 of 4)	1	1,725	773
	Partial use (2 of 4)	1	1,150	500
	Partial use (1 of 4)	1	575	261
Meeting Room	1	72	24	
Training Room	All courts (4 of 4)	1	160	90
	Partial use (3 of 4)	1	120	72
	Partial use (2 of 4)	1	80	45
	Partial use (1 of 4)	1	40	18
Japanese-style Room	All courts (2 of 2)	1	48	30
	Partial use (1 of 2)	1	24	15



Dojo 1



Dojo 2

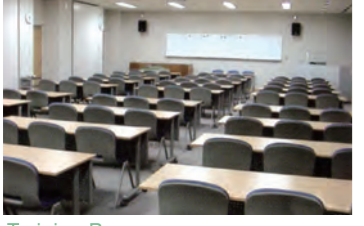

Training Room



Meeting Room

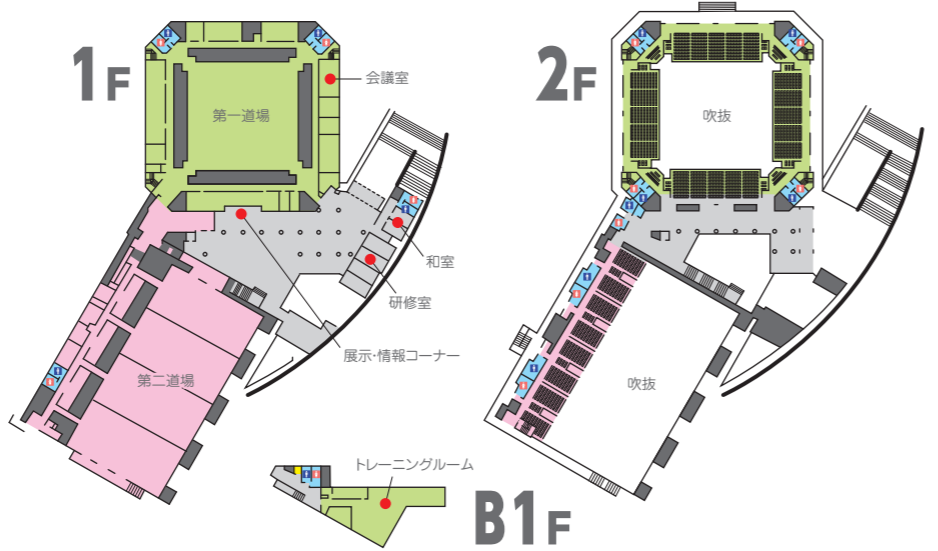

# Victorina · Wink Gymnasium

Facilities include Stadium 1 (3 volleyball / basketball courts), Stadium 2 (1 volleyball / basketball court), and a sumo ring.



**Address:** 670-0971 Nishinobusue 90 **Tel:** (079) 298-0951  
**Holidays:** 12/28 - 1/4 **WiFi:** None  
**Parking:** Available (public)  
**URL:** <http://himeji-machishin.jp/sports/>  
**Notes:** Café available

Venue name	Floor	Area (m <sup>2</sup> )	Capacity (persons)
Stadium 1	1	2,183	Fixed: 1,980 Movable: 896
Stadium 2	3	740	—
Sumo Ring	3	204	—



# Wink Stadium

The stadium can be used for hard and soft baseball (it cannot be used for softball). It is equipped with facilities such as an office, a press room, team rooms, meeting rooms, changing rooms, indoor practice areas, a recording room, and a broadcasting room.



**Address:** 670-0794 Jida 540 **Tel:** (079) 293-8574  
**Holidays:** 12/28 - 1/4 **WiFi:** None  
**Parking:** Available (public)  
**URL:** <http://himeji-machishin.jp/sports/>

Venue name	Area (m <sup>2</sup> )	Capacity (persons)
Ballpark	12,942	14,000

Right and left fields: 100 m, infield: 120 m, infield stands: 8,000 seats, outfield stands: 6,000 seats  
 Infield: dirt, outfield: natural grass  
 No lighting



# Himeji City General Sports Center

Facilities include a large stadium (volleyball, basketball, table tennis), a heated pool, a judo and kendo arena, and a kyudo archery range.

**Address:** 670-0976 Chuji 453 **Tel:** (079) 293-1321  
**Holidays:** 12/28 - 1/4 **WiFi:** Available (in some areas)  
**Parking:** 190 cars **URL:** <http://himeji-machishin.jp/sports/>

Venue name	Floor	Area (m <sup>2</sup> )	Note
Kendo arena	2	823	115 spectator seats at 4 courts
Spectator seats	2	—	1,000
Kyudo archery range	1	—	27.2 m, for 4 archers
Judo ring	1	823	115 spectator seats at 4 courts
Training room	1	282	
Table tennis arena	1	431	10 cars
Heated pool	1	1,279	Children's pool also available
Arena	1	2,218	3 volleyball courts
			3 basketball courts
			12 badminton courts



\*The stadium, kendo hall and judo hall can be partially used.  
 \*There is a conference room (97m<sup>2</sup>), an executive room (49.3m<sup>2</sup>), etc.



# KD Himeji Minato Dome

This all-weather facility can be used for sports, exhibitions, and various other events.



Venue name	Floor	Area (m <sup>2</sup> )
Arena		
Amateur Sports	1	2,675
Other Events		

**Address:** 672-8064 Shikama-ku, Hosoe 1228-2 **Tel:** (079) 231-4477  
**Holidays:** Second Tuesday of every month (Wednesday if the second Tuesday falls on a national holiday), 12/28 - 1/4  
**WiFi:** None  
**Parking:** 100 cars (The multipurpose plaza can be used as temporary parking for an additional 110 cars)  
**URL:** <http://www.himejiminatodome.jp/>

**Founded in Meiji 43**  
**Nadagiku Sake Brewery**  
<http://www.nadagiku.co.jp/gourmet/nishigura>  
 Enjoy a meal at the quaint wooden sake brewery, which was established at the founding in 1910. Please use these facilities for banquets as part of your convention, or take a tour of the sake brewery.



**Address:** 670-0972 Tegara 1-121  
**Tel:** (079) 285-3111  
**Holidays:** Year-end and New Year's holidays  
**WiFi:** None **Parking:** 10 cars

Venue name	Floor	Capacity (persons)	
		Seats	Standing room
Nishikura	2	45	120
Nakagura	1	45	—
Kamaba	1	45	—

*Nishikura*

**Soraniwa**  
<http://www.soraniwa-setre.com/>  
 8-minute walk from Himeji Station. This restaurant overlooks Himeji Castle, a World Heritage Site and National Treasure. At SORA NIWA, we serve the blessings of the earth and sea from Himeji and Harima. A plate of vegetables from our contracted farmers is waiting for you.



**Address:** 672-0023 Honmachi 241  
**Tel:** (079) 281-0070  
**Holidays:** Mondays and Tuesdays **WiFi:** None

Venue name	Floor	Capacity (persons)	
		Seats	Standing room
Restaurant	6	60	—
Banquet Hall	7	50	80

**Himeji Castle Nishi-Oyashiki-ato Garden Koko-en**  
**Kassui-ken Restaurant**  
<http://www.himeji-machishin.jp/tyokka/koko-en/kassuiken/>  
 This Japanese garden is located to the west of Himeji Castle, a World Heritage Site and National Treasure. Enjoy a calm, relaxing time while looking at the seasonal scenery.



**Address:** 672-0023 Honmachi 68  
**Tel:** Please contact the Himeji Convention & Visitors Bureau with any inquiries.  
**Holidays:** 12/29 and 12/30 **WiFi:** None

Venue name	Floor	Area(m <sup>2</sup> )	Capacity (persons)	
			Seats	Standing room
			55	—

**Harima-no-Kuni Sosha Shrine**  
<http://sousha-wedding.com/banquet/>

Harima-no-Kuni Sosha Shrine has a 1,400-year history. It enshrines the deities Itate-no-Okami and Hyozu-no-Okami. Every day, we look forward to serving you the seasonal blessings of Harima, a treasure trove of food prepared using authentic Japanese tastes and methods, served at our restaurant and as wedding dishes.



**Address:** 670-0015 Sosha Honmachi 190  
**Tel:** (079) 224-1111 (Switchboard)  
**Holidays:** None **WiFi:** None **Parking:** 30 cars

Venue name	Floor	Area(m <sup>2</sup> )	Capacity (persons)	
			Seats	Standing room
Choseiden	1	185	90	120
Horai	2	170	60	80
Harima	2	205	120	140

**Himeji Gokoku Shrine**  
<https://www.shirasaginomiya.com/reception.html>

There are large windows on three walls to create an open, bright, and relaxed venue where you can see scenery unique to the area, including Himeji Castle, from the windows. This breezy space lets you experience the beauty of the four seasons. The unique location of the Himeji Gokoku Shrine will delight all visitors.



**Address:** 670-0012 Honmachi 118 **Tel:** (079) 224-0559  
**Holidays:** Tuesdays **WiFi:** None **Parking:** Available

Venue name	Floor	Capacity (persons)	
		Formal dining	—
Annei-no-ma	2	60	—

**Wedding Manor House La Viena Himeji**  
<https://www.laviena.co.jp/>

It can accommodate small meetings to parties of up to 250 people. All rooms are equipped with screens and projectors. A wide range of course meals, party food, and boxed lunches are available upon request, and catering service is also available. 3-minute walk from Arcrea Himeji, shuttle bus available from JR Himeji Station.



**Address:** 670-0836 Kamiyacho 3-31 **Tel:** (079) 282-1001  
**Holidays:** Wednesday (open on public holidays)  
**WiFi:** Available **Parking:** 180 cars

Venue name	Area(m <sup>2</sup> )	Capacity (persons)	
		Seats	Standing room
Lamuse	280	100	150
Arietta	240	80	100
d'Orsay	280	100	150
Vincent	445	180	250

**The Royal Classic Himeji**  
[https://www.bellclassic.co.jp/kinki/royal\\_himeji/](https://www.bellclassic.co.jp/kinki/royal_himeji/)

The expansive grounds include an open-air garden venue, where guests can enjoy the changing seasons on the premises. There are seven venues of various sizes, all equipped with screens and projectors, are available for a wide range of events, from weddings to various ceremonies, meetings, and parties. Parking for 250 cars is available, and there is a shuttle bus pick-up service from JR Himeji Station.



**Address:** 670-0943 Ichinogo Nishinono 841 **Tel:** (079) 222-1200  
**Holidays:** None **WiFi:** Available **Parking:** 250 cars

Venue name	Floor	Area(m <sup>2</sup> )	Capacity (persons)			
			Dinner	Buffet	School-style	Theater-style
Royal	4	516	250	370	320	520
Loire	4	258	100	170	160	200
Edinburgh	4	252	100	170	160	200
Vent Vert	3	111	40	50	70	90

**Seiko Club**  
<https://www.seiko-club-gr.com/party.html>

We meet the various needs of our customers with our experience, service, and proposal capabilities cultivated over many years. We offer a wide range of services including party food for academic conferences, get-togethers, and social gatherings, as well as venue production, floral arrangements, and catering. The tasteful venue of our sister restaurant "Fukutei" is also available.



**Address:** 670-0932 Shimoderamachi 43  
 Inside the Himeji Chamber of Commerce and Industry  
**Tel:** (079) 281-6800 **Holidays:** Wednesdays and New Year's holidays  
**WiFi:** Available **Parking:** 270 cars

Venue name	Floor	Area(m <sup>2</sup> )	Capacity (persons)	
			Seats	Standing room
Salon de Luce	1	377	210	300
Rose	2	463	300	350
Mimosa	7	140	60	80
Iris	7	208	80	100

**Himeji Monolith**  
<http://produce.novarese.jp/himeji-monolith/>

Himeji Monolith, designated by Himeji City as an important building in the cityscape to commemorate 80 years since the construction of the former Himeji Telegraph Bureau in front of Himeji Castle, is a building that reproduces the original building's sophisticated stage.



**Address:** 670-0015 Sosha Honmachi 115 **Tel:** (079) 286-5858  
**Holidays:** Year-end and New Year's Holidays, every Tuesday and Wednesday (except holidays), not closed if there is a banquet being held  
**WiFi:** None **Parking:** Free parking available

Venue name	Floor	Area(m <sup>2</sup> )	Capacity (persons)	
			Seats	Standing room
Dining room	2	223	120	150
Lounge	1	202.5	60	100
Crystal Hall	1	96	48	60
Private Room 1	1	27.49	14	20
Private Room 2	1	54.24	28	40

# Unique Venues Himeji Plan

You can use unique venues, including Himeji Castle, a World Heritage Site and National Treasure, as venues for your various meetings, including receptions and parties. Please make use of these venues to make hosting your convention at Himeji even more attractive and valuable.



Himeji City Museum of Art



San-no-Maru Plaza

## Uses of Unique Venues

- Reception parties
- Various ceremonies
- Conferences, academic conferences, seminars
- Product unveilings
- Press conferences, exhibitions, etc.



San-no-Maru Nishitakadai



Ni-no-Maru Plaza



Garden Koko-en



Himeji Literature Museum



San-no-Maru Plaza



Himeji Literature Museum



Shosha Handicraft Museum

## Available facilities

Facility
San-no-Maru Plaza (all)
San-no-Maru Plaza (half)
San-no-Maru Nishitakadai
San-no-Maru Large Column Plaza
Ni-no-Maru Plaza
Himeji Castle Nishi-Oyashiki-Ato Garden Koko-en
Himeji City Museum of Art (front garden)
Himeji Literature Museum (Bokeitei West Plaza, rooftop terrace)
Himeji City Shosha Handicraft Museum

## Location of available facilities



## World Heritage Site and National Treasure Himeji Castle

Built over 400 years ago, Himeji Castle was constructed on a site with over 600 years of historical significance. It is a symbol of Himeji and contains many national treasures, important cultural properties, legends, and more.

Address: 670-0012 Honmachi 68 Tel: (079) 285-1146 (Himeji Castle Management Office)  
 Opening hours: 09:00-17:00 (entry 16:00)  
 \*09:00 - 18:00 in summer (April 27-August 31) (entry 17:00)  
 Admission fee: Adults (18 years old and over) 1,000 yen,  
 Students (Elementary, Junior High, and Senior High School) 300 yen  
 30 persons and over Adults 800 yen, Student 240 yen  
 Closed (scheduled): 12/29,30



## Special Head Temple of the Tendai Sect Shoshazan Engyo-ji temple

Located in the northwest part of Himeji City, Engyo-ji Temple of the Tendai Sect was opened in 966 by the Shoku Shonin and is called the Mt. Hiei of the West.

Address: 671-2202 Shosha 2968  
 Tel: (079) 266-3327 (Office), (079)266-3240 (Engyoji Kaikan)



## Himeji Castle West Imperial Palace Ruins Garden Garden Koko-en

This Japanese style garden with a path around a pond was opened in 1992 with a view of Himeji Castle, the World Heritage Site and National Treasure. You can enjoy walking through the gates and hedges of nine different styles of gardens.

Address: 670-0012 Honmachi 68 Tel: (079) 289-4120 Closed (scheduled): 12/29,30  
 Opening hours: (April 27-August 31) 09:00-18:00 (entry 17:30),  
 (September 1-April 26) 09:00-17:00 (entry 16:30)  
 Admission fee: Adults (15 years old and over) 300 yen, Students (Elementary and junior high school) 150 yen, 30 persons and over Adults 240 yen, Student 120 yen



## A Designated National Research and Development Corporation RIKEN Spring-8 Center

We further comprehensive research on synchrotron radiation, focusing on SPring-8, a large synchrotron radiation facility that can generate the world's highest performance radiation.

Address: 679-5148 Sayo-gun, Sayo-cho Kouto 1-1-1  
 About facility tour/ Tel: (0791) 58-0909 E-mail: rikenvisit@spring8.or.jp



Himeji City Museum of Art



Hyogo Prefectural History Museum



Himeji Literature Museum



Shosha Handicraft Museum



Himeji Central Park



Japan Toy Museum



Taiyo Park



Enzan Memorial Museum of Arts & Crafts

The north area in the station

1 Himeji Green Hotel Sakamoto

Address: 670-0016 Sakatomomachi 100 Tel: (079) 289-0088 WiFi: Available Parking: 80 cars

Table with 2 columns: Room type, number of rooms



2 HOTEL WING INTERNATIONAL HIMEJI

Address: 670-0921 Watamachi 132 Tel: (079) 287-2111 Parking: 50 cars

Table with 2 columns: Room type, number of rooms



4 Hotel Fosse Himeji

Address: 670-0911 Junishomae-cho 54 Tel: (079) 283-5963 Parking: Contract parking lot

Table with 2 columns: Room type, number of rooms



5 Himeji Green Hotel Tatemachi

Address: 670-0903 Tatemachi 83 Tel: (079) 288-2000 Parking: 35 car Notes: There is a view public bath

Table with 2 columns: Room type, number of rooms



7 APA Hotel (the Himeji Station north)

Address: 670-0926 Higashiekimae-cho 98 Tel: (079) 284-4111

Table with 4 columns: Room type, number of rooms, Room type, number of rooms

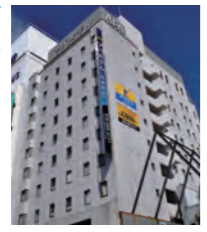

8 Comfort hotel Himeji

Address: 670-0935 Hojoguchi 1-50-3 Tel: (079) 286-8511 Parking: 27 cars

Table with 2 columns: Room type, number of rooms



10 Toyoko Inn Himeji-eki Shinkansen Kita-guchi

Address: 670-0913 Nishiekimae-cho 52-2 Tel: (079) 226-1045 Parking: 62 cars

Table with 2 columns: Room type, number of rooms



11 Hotel Monterey Himeji

Address: 670-0927 Ekimae-cho 60 Tel: (079) 224-7111 Parking: 197 cars Notes: Rooms 274

Table with 4 columns: Room type, number of rooms, Room type, number of rooms



13 Himeji-Ekimae Universal Hotel South Exit

Address: 670-0961 Nonen-cho 26 Tel: (079) 222-4000 Parking: 37 cars Notes: Large Bath

Table with 2 columns: Room type, number of rooms



14 Hotel Nikko Himeji

Address: 670-0962 Minamiekimae-cho 100 Tel: (079) 222-2231 Parking: 250 car

Table with 4 columns: Room type, number of rooms, Room type, number of rooms



3 Hotel Claire Higasa

Address: 670-0911 Junishomae-cho 22 Tel: (079) 224-3421 Parking: 25 car Notes: There is a view public bath

Table with 4 columns: Room type, number of rooms, Room type, number of rooms

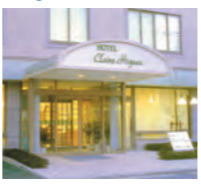

6 Daiwa Roynet Hotel Himeji

Address: 670-0927 Ekimae-cho 353 Tel: (079) 287-0655 Parking: 52 car

Table with 2 columns: Room type, number of rooms

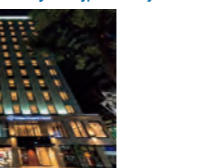

9 Hotel Livemax Himejiekimae

Address: 670-0912 Minamimachi 14-2 Tel: (079) 282-4400 Parking: 3 car

Table with 2 columns: Room type, number of rooms



The south area in the station

12 Toyoko inn Himeji Station Shinkansen South Gate

Address: 670-0962 Minamiekimae-cho 97 Tel: (079) 284-1045 Parking: 66 car

Table with 2 columns: Room type, number of rooms



16 DORMY INN HIMEJI

Address: 670-0964 Toyozawa-cho 160-2 Tel: (079) 286-5489 Parking: 26 cars Notes: Large bath

Table with 2 columns: Room type, number of rooms

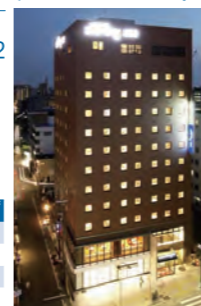

19 Hotel Livemax Himejishiyakusho-mae

Address: 670-0955 Yasuda 3-5 Tel: (079) 226-7400 Notes: 1 person 1 room

Table with 2 columns: Room type, number of rooms



22 JR Clement Inn Himeji

Address: 670-0962 Minamiekimae-cho 33-1 Tel: (079) 280-1123 Parking: 12 cars

Table with 2 columns: Room type, number of rooms

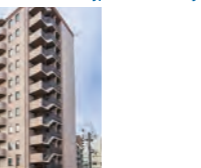

17 HOTEL CROWN HILLS HIMEJI

Address: 670-0965 Higashinobusue 3-56 Tel: (079) 222-8000 Parking: 100 cars Notes: Large bath

Table with 2 columns: Room type, number of rooms



20 Richmond Hotel Himeji

Address: 670-0961 Nonen-cho 2-7 Tel: (079) 225-6255

Table with 2 columns: Room type, number of rooms

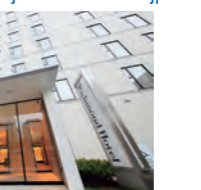

18 Himeji Castle Grandvrio Hotel

Address: 670-0940 Sanzaemonbori nishi-no-machi 210 Tel: (050) 5847-7770 Parking: 180 cars, 10 bus Notes: Large bath

Table with 3 columns: Room type, number of rooms, number of rooms

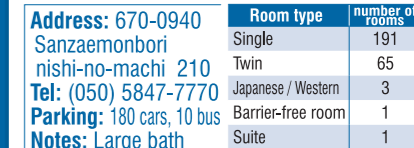

21 Hotel Livemax PREMIUM Himejeki-minami

Address: 670-0964 Toyozawa-cho 144 Tel: (079) 284-2210 Notes: Large bath

Table with 2 columns: Room type, number of rooms



Area in a suburb

23 Yumenoi

Address: 671-2103 Yumesaki-cho maenosho 187 Tel: (079) 336-1000 Parking: 100 cars Notes: Large bath, etc

Table with 2 columns: Room type, number of rooms



24 Yumenoi-an Yuyakekoyake

Address: 671-2103 Yumesaki-cho maenosho 187 Tel: (079) 336-0457 Parking: 100 cars Notes: Private bath, etc

Table with 2 columns: Room type, number of rooms

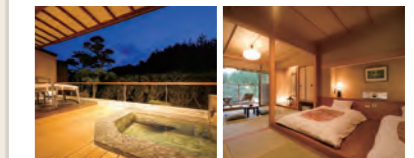

25 Ueyama ryokan

Address: 671-2112 Yumesaki-cho shiota 287 Tel: (079) 336-0020 Parking: 50 cars Notes: Large bath

Table with 2 columns: Room type, number of rooms



26 Hotel Aston Plaza Himeji

Address: 672-8035 Shikamaku nakashima 763-1 Tel: (079) 243-1500 Parking: 50 cars Notes: Large bath, etc.

Table with 2 columns: Room type, number of rooms



27 New Sunpia Himeji Yumesaki

Address: 671-2112 Yumesaki-cho okimoto 432-56 Tel: (079) 335-5551 Parking: 200 cars Notes: Large bath, etc.

Table with 3 columns: Room type, number of rooms, number of rooms



28 SETRE Hightlandvilla HIMEJI

Address: 670-0891 Hiromineyama 224-26 Tel: (079) 284-3010 Parking: 40 cars Notes: Large bath

Table with 2 columns: Room type, number of rooms



29 Hotel Sunshine Aoyama

Address: 671-2223 Aoyama minami 4-7-29 Tel: (079) 276-1181 Parking: 400 cars

Table with 2 columns: Room type, number of rooms



30 Hoshinoko Yakata

Address: 671-2222 Aoyama 1470-24 Tel: (079) 267-3050 Parking: 37 cars, 1 bus

Table with 3 columns: Room type, number of rooms, number of rooms



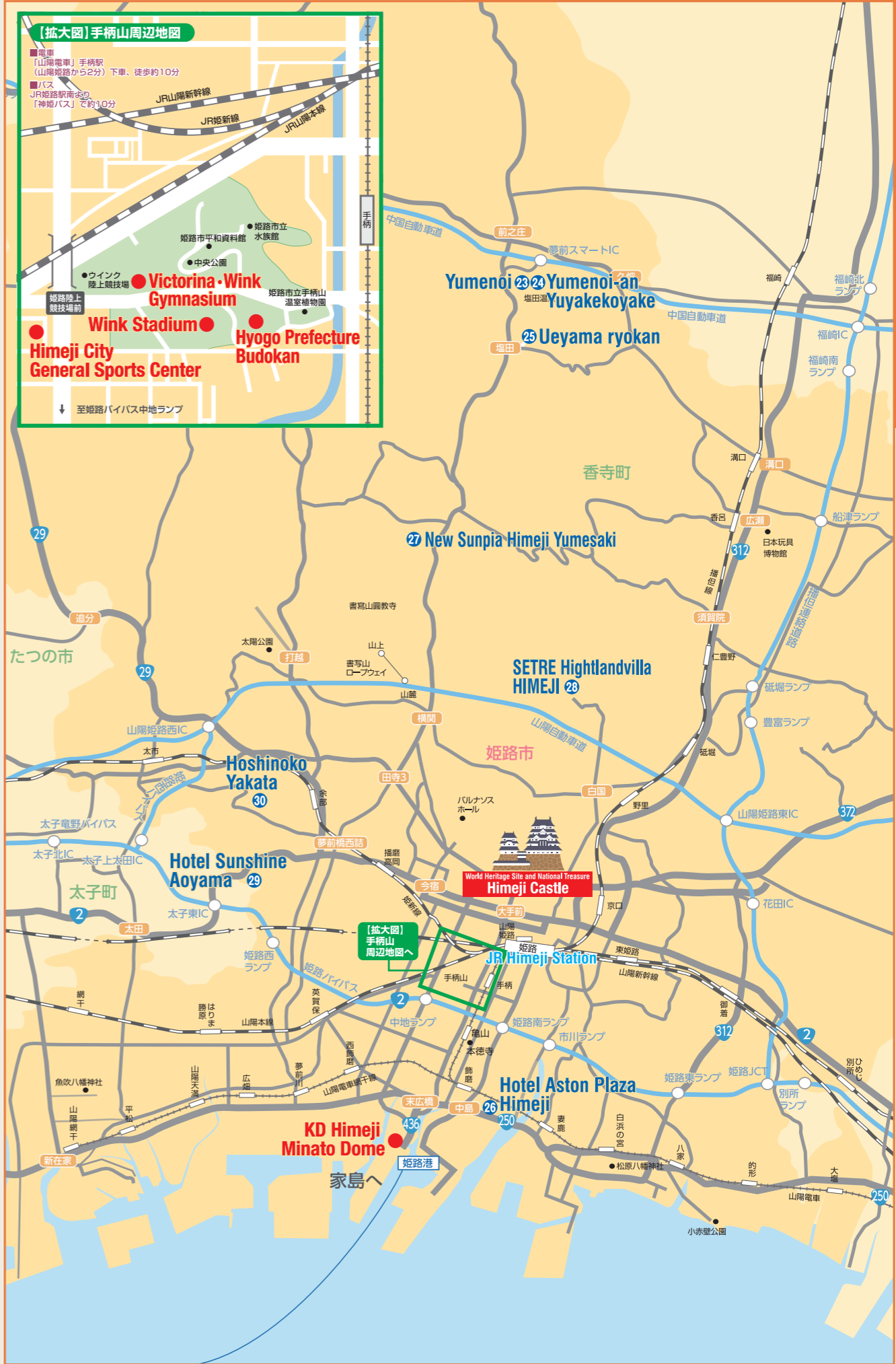

Subsidies based on the number of hotel guests in the city may be issued for business and academic conferences, corporate conventions, sporting events, cultural events, training camps, etc. that cover an area larger than Kinki and are held in Himeji.

	Subsidy type	Conditions
Subsidies for holding conventions	<b>Congress</b> • Conferences, meetings, seminars, trainings, etc.	<b>Number of overnight guests from outside of Hyogo × 2,000 yen</b> • Kinki Regional tournament or higher, or event of equivalent scale • 25 or more participants or overnight guests from outside of Hyogo • Maximum amount: International 4,000,000 yen Domestic 3,000,000 yen
	<b>Academic Conferences</b> • Conferences held to present academic research, composed of researchers, and hosted by organizations that aim to improve and develop academic research.	
	<b>Business Conventions</b> • Conferences hosted by companies, including meetings related to incentives and seminars, conventions, research meetings, etc. that are not for-profit.	<b>Number of overnight guests from outside of Hyogo × 1,000 yen</b> • Kinki Regional event or higher, or event of equivalent scale • 25 or more participants or overnight guests from outside of Hyogo • Maximum amount: 500,000 yen
	<b>Sports Tournaments</b> • Tournaments organized or co-sponsored by a competitive organization or its subsidiary organization whose purpose is the promotion and development of competition through the tournament.	<b>Number of overnight guests from outside of Hyogo × 500 yen</b> • Kinki Regional tournament or higher, or event of equivalent scale • 50 or more participants or overnight guests from outside of Hyogo • Maximum amount: 1,000,000 yen
	<b>Cultural Competition</b> • Recitals and competitions sponsored or co-sponsored by a organizations or their subordinate organizations for the purpose of promoting and developing culture and arts.	
	<b>Training Camps</b> • Sports, cultural, or other not-for-profit training camps held for the purpose of improving skills or exchange and organized by clubs comprising students of schools as defined by the School Education Act, or organizations and corporations belonging to sporting or cultural associations.	<b>Number of overnight guests from outside of Hyogo × 300 yen</b> • 50 or more participants or overnight guests from outside of Hyogo • Maximum amount: 300,000 yen
<b>Shuttle bus subsidy</b>	<b>Number of shuttle buses × 50,000 yen</b>	• Convention Subsidies must apply to be eligible • 300 or more participants • Transport between two or more venues in the city (excludes socializing events and sightseeing spots) • Maximum amount: 250,000 yen (5 buses) • May not overlap with subsidies for sightseeing buses or banquet buses.
<b>Sightseeing bus subsidy</b>	<b>Number of sightseeing buses × 50,000 yen</b>	• Convention Subsidies must apply to be eligible • Visits to sightseeing spots in the city • At least 25 riders per bus • Maximum amount: 250,000 yen (5 buses) • May not overlap with subsidies for shuttle buses or banquet buses.
<b>Banquet bus subsidy</b>	<b>Number of banquet buses × 50,000 yen</b>	• Convention Subsidies must apply to be eligible • Transfer from Convention site to Banquet place • At least 25 riders per bus • Maximum amount: 500,000 yen (10 buses) • May not overlap with subsidies for shuttle buses or sightseeing buses.
<b>Excursions Bus subsidy</b>	<b>Number of sightseeing buses × 50,000 yen</b>	If international academic conferences, national tournaments, etc. held in Himeji City hold excursions to destinations outside of Himeji City • At least 25 riders per bus • Maximum amount: 250,000 yen (5 buses)
<b>Hybrid meeting subsidy</b>	<b>Subsidy is 50% of above fee</b>	• Hybrid meeting system must be ordered to the company in Himeji city. • Hybrid meeting system renting fee, set up fee, operator fee, Web set up fee, data usage fee, and meeting fee during preparation for hybrid meeting • It is necessary to apply to the company in Himeji city. • Maximum amount: 500,000 yen
<b>Subsidy to promote the use of Unique venue</b>	<b>Subsidy is 50% of above fee</b>	• Convention Subsidies must apply to be eligible. • Renting fee for tents, stages, tables, chairs, speakers, microphones, other audio equipment, banners, and etc. Fee for setting up and tear down the event place. Cancellation fee in case of rain • It is necessary to apply to the company in Himeji city. • Maximum amount: 1,500,000 yen
<b>Omotenashi subsidy for feeling Himeji</b>	<b>Subsidy is 50% of above fee</b>	• Convention Subsidies must apply to be eligible. • Attraction fee for traditional cultural program or fee for breaking open a Japanese sake barrel at a banquet • Fee of traditional crafts including Himeji leather products to members attending the meeting • It is necessary to apply to the company in Himeji city. • Maximum amount: 500,000 yen

- Notes:**
- If the number of overnight guests exceeds the number reported at the time of application, the number reported at the time of application will be used.
  - Please submit a survey of participants from outside of Hyogo.  
\* You are required to submit surveys from at least 20% of overnight participants.
  - Please submit a Project Cancellation / Change Application to make any changes (number of people, etc.) or to cancel after your application has been approved.
  - Conventions corresponding to any of the following are not eligible for subsidies.
    - Political or religious activities
    - Activities that violate public morals
    - Activities that receive other grants or subsidies from Himeji City
    - Activities that collect admission fees from some number of their participants
    - Other activities recognized by the board chairman to be inappropriate
  - Subsidies will be transferred to the financial institution account belonging to the organizer after results are reported. \* Personal accounts may not be used.

Other Support

Available hosting support for conventions, academic conferences, business conferences, and sports tournaments

1 Pamphlets

- Himeji Sightseeing Guidebook (A5-size booklet)
- Himeji Tourist Guide Map (6-fold)
- \* Also available in English, Chinese (traditional and simplified), Korean, and other languages.

For events of the following size

We will provide the same number as you have applicants for your event (with some restrictions for especially large events). However, this may change depending upon supplies.



2 Convention bags

- Non-woven fabric
- Vinyl
- \* Up to 200 non-woven fabric or vinyl bags available free of charge  
A fee of 50 yen per bag applies for every bag after the first 200.

For events of the following size	Number of participants
We will provide the same number as you have applicants for your event (with some restrictions for especially large events). However, this may change depending upon supplies.	

3 Discount tickets for Himeji City Tourist Facilities

Approximately 20% off admission fees

For events of the following size	Number of participants
Kinki / Hyogo Prefecture level-events and higher *Event name printed on the cover	100 or more



4 Welcome sign

- Displayed at:
- JR Himeji Station Central Concourse South Exit
  - JR Himeji Castle Exit

For events of the following size	Number of participants
Kinki-level events and higher (Kinki, West Japan, national, and international events)	100 or more
Kinki / Hyogo Prefecture-level events	1,000 or more (Negotiable)